



Cruise France by hotel barge

**LUCIOLE**



## Welcome aboard

Cruise on the Luciole, in beautiful Burgundy, for the vacation of a lifetime.

Hotel barge Luciole cruises the exceptional Nivernais Canal, widely considered the most beautiful in France.

The barge accommodates twelve passengers in eight en-suite cabins, with an attractive saloon and inviting sundeck.

Our professional crew of six maintain the warm and friendly, yet caring atmosphere for which we are noted.

On board, guests will experience the gastronomy of France, with fine regional wines and delicious gourmet meals.

The week's itinerary combines cruising the waterway with daily excursions in the barge's private bus, to visit famous vineyards, Medieval towns, historic châteaux and colourful markets.

While the Luciole cruises the canal, soak up the sun on deck or stroll down the towpath. We also have bicycles for those wishing to explore nearby villages.

A family business, run by mother and son



Penny



Will



## The Luciole

Built in 1926 as a mule drawn working vessel, the Palinurus was converted into a hotel barge in 1966, becoming the first of her kind in France. We began in 1976, renaming her 'Luciole', French for Firefly. Over the years she has been refitted and updated throughout.



Our saloon is large and welcoming, with comfortable seating and dining areas - a light and bright place to relax and dine. The open-bar is well-stocked and there is a library, music system and free mobile Wi-Fi.



The large picture windows of the saloon offer splendid views of the glorious Nivernais landscape with reflections of sunset as supper is served.



On the large raised sun-deck, passengers can relax and enjoy the wonderful vista as we cruise. The perfect place for morning coffee, afternoon teas or sundown cocktails under the parasol.



The Luciole's interior is spacious and tastefully designed. Our eight en-suite cabins include three doubles, three twin bedded cabins and two with single beds.



Comfortable accommodation with all the modern conveniences. All cabins have en-suite facilities, good storage, openable windows and air-conditioning.



## Nivernais Canal

The Canal du Nivernais takes a dramatic and varied route, with breathtaking panoramas at each twist and turn. Around each bend the vista changes, as the waterway weaves through the heart of Burgundy's most beautiful scenery.

The majestic River Yonne interweaves with man-made canal, creating an enchanting waterway, where time stands still. A total of thirty-five hand-operated locks mark the way, each with its own house and keeper, providing the opportunity to disembark for a stroll or to cycle alongside on the smooth towpath beside the water.

Built in 1784, the waterway was once important for transporting goods to Paris. Today the canal is a sleepy backwater, where few other barges navigate. A lost oasis of the canal system, where little has changed over the decades.



## Cruising

This is no ocean voyage. The pace is gentle, there is no rocking of the boat. As the barge gently slips through the water; there is time to look around, admire the flora and absorb the beauty of the countryside. Our raised sundeck lends itself to wonderful views as we pass by 12th Century farms and even a German World War II air base. Luciole halts at each lock, fitting into it snugly, rising to meet the water before making her way forward on to the next chapter of her journey. Guests may even try their own hand at barge steering – under supervision of the Captain!

The Luciole cruises between two key destinations: the city of Auxerre and the Medieval town of Clamecy further south. Between these points; willow trees hang into the water while white cattle graze, offering the dream artistic landscape. Herons stand sentinel, geese cluster by a farm's gate and at nighttime swathes of stars fill the sky. There is tranquility here.



## Food & wine

Meals on board are treasured times, to share with fellow passengers, whether a summer lunch or candlelit dinner. The four course evening meal is the gastronomic highlight of each day.

Glistening glasses and starched linen napkins set the scene of a dinner party with friends. Our experienced chef is encouraged to be imaginative, marrying French cuisine with a contemporary twist, using fresh local ingredients.

The inspiring menus are carefully paired with the wines we serve – selections from Burgundy, Bordeaux and the Loire Valley - We take you on a wine tour of France, through the regions and their grape varieties, combining established vintages with new discoveries.



Wake up to fresh croissants and pastries from local bakeries along our route. The culinary delights continue through lunch, with savory dishes and a feast of salads. We introduce over twenty delicious French cheeses, from creamy Camembert to the famous Roquefort.

Tea and coffee are available throughout the day - or perhaps something stronger from the 'open bar'. Special diets are easily catered for aboard the Luciole. Just advise us before your cruise and have a word with the chef when you arrive on board.







## Auxerre

The skyline of Auxerre rises dramatically above the River Yonne. Dominated by the 11th Century Cathedral of St Etienne and the even older 5th Century Abbey of St Germain. This is one of the most spectacular waterfronts in Europe.

The city was originally a Gallo-Roman town; a busy port and trading centre. Today, the 1483 clock tower looks down upon an elegant shopping area, with ample opportunities for discovering French fashion or simply to relax in one of the many charming French cafes, with a chocolat chaud or chilled bière.

The Luciole moors below the imposing Cathedral. With sweeping bridges upstream and the city itself providing a backdrop beyond compare.

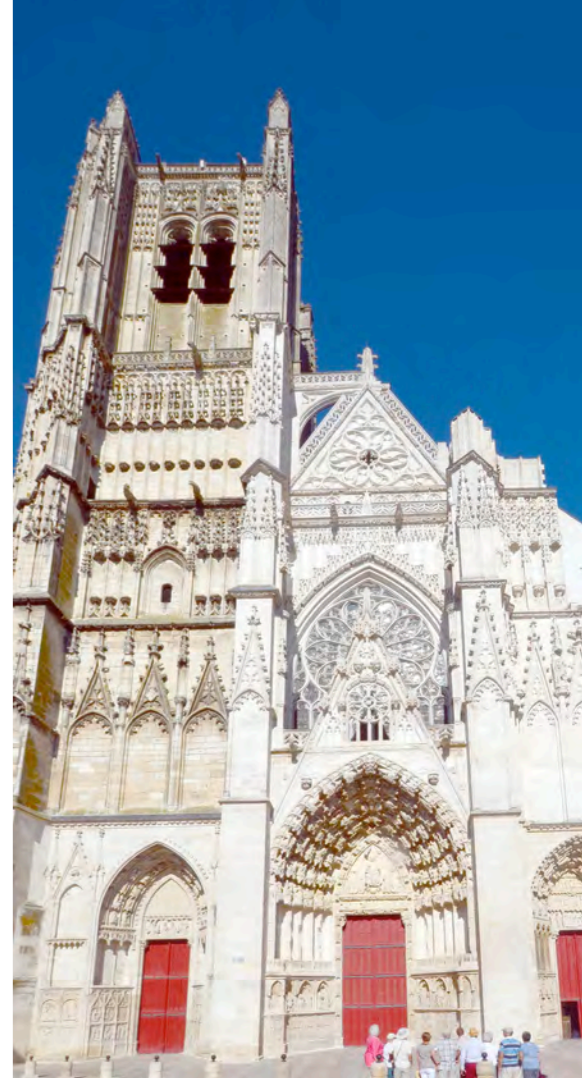



## Wine tasting

For a memorable wine-tasting experience we visit the nearby vineyards of Chablis. Renowned amongst connoisseurs worldwide, Chablis produces the noblest of wines.

Proud domaine owners have tended the soil here for generations, protecting the vines from winter frosts and nurturing the fruit-bearing plants during the summer sun. The most prestigious wines are grown on a hill-side area of one square kilometer, called La Colline des Grands Crus. During the vendange, pickers gather these grapes by hand to ensure their quality.

An excursion to Chablis reveals breath-taking views across the vineyards. A wine-tasting led by the vigneron themselves introduces different vintages and their background - exploring the complexities and pleasures of this distinct wine.





## Noyers-sur-Serein

Nestling in a meander of the River Serein, this enchanting fortified village is officially one of the most beautiful villages in France. Winding cobbled streets invite one to explore the architectural detail of turreted dovecotes and gargoyles.

Here in the 12th Century, the Dukes of Burgundy built France's largest château of the age. As such it was a threat to the Kingdom and in 1599 King Henri IV encouraged the townsfolk to raze it, plundering the spoils, from which they built and furnished their own properties, as is still evident today in the cottage facades. Restoration is now under way to rebuild the château. Working from old manuscripts, present-day masons are re-shaping the ramparts of long-ago.

We visit on market day, providing an opportunity to buy gifts from the local stalls selling silk scarves and jewelry. Ceramics are made and sold in the rustic pottery workshop, while leather bags and belts are also on sale. Freshly baked gougères or macarons are tempting to taste as you wander through this picturesque village.



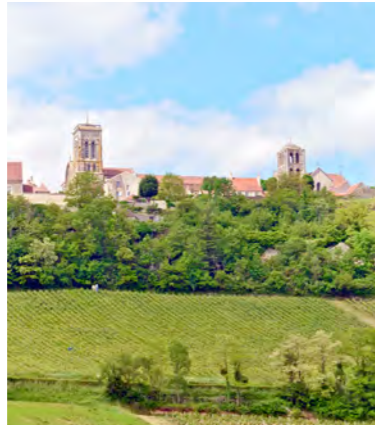

## Vézelay

Once a center of Medieval Europe, now a World Heritage UNESCO site, the Basilica of St Mary Magdelene is one of France's architectural gems, a stunning blend of Gothic and Romanesque styles. It was here that Saint Bernard preached the Second Crusade, and in 1190 Richard the Lionheart, King of England, joined forces with Philip Augustus of France to launch the Third Crusade.

The Relics of Saint Mary Magdelene are enshrined in the crypt. Since the early 11th Century pilgrims have arrived in their masses to pay homage along the pilgrim trail to Santiago de Compostela in Northern Spain.

Crowning The Eternal Hill, the spectacular Basilica is the focal point of a huge expanse of rich, rolling countryside. On the southern flanks monks still tend to the vines of ancient vineyards – producing an excellent wine that we are delighted to serve on the Luciole.

Visitors may wander down through the village at their own pace, taking the time to browse the boutique clothes and antique shops, craft expositions and cafes.



## Bazoches

The 12th Century Château of Bazoches in 1675 became home to the Marquis de Vauban, genius engineer and military tactician of Louis XIV. During his lifetime Vauban built thirty-seven new fortresses, and radically upgraded three hundred others to withstand attack. Vauban participated in many sieges, frequently leading from the front, as is evident from the musket ball dents in his suit of armor.

Turreted, elegant and set in a pastoral landscape with views across the valley. This handsome château offers new insights into bygone France and the history of the nation. Still owned by Vauban's descendants, both the château and its' grounds have been lovingly restored. The Great Hall contains many exhibits, featuring examples of strategic wartime plans and fort designs. Spiral stone staircases lead to bedrooms, splendid in the affluence of the Baroque era, while the downstairs area features a library of rare books detailing the history of France.

## Theme charters

For group bookings of the Luciole, we can tailor the perfect itinerary.

We also run themed weeks throughout the season combining specialized activities with on-shore excursions and, of course, cruising the Nivernais Canal.

← Charter groups only

Individuals & Charter groups →



### Custom itineraries

Bespoke and flexible itineraries for family and friends are available charter groups.

### History Cruises

Explore the deep history and culture of Burgundy and France. On our in depth history tours with friendly expert guidance.

### Adventure Cruises

Thrills, fun and adventure for mixed ages, with cave climbing, canoeing, horse riding and treetop zip-lining.

### Ladies' Cruises

An itinerary of pampering and relaxation, combines a spa day, colour consultancy, cookery demonstrations and garden visits.

### Photography Cruises

A week of photography amidst picturesque scenery and medieval villages. We provide the support, know-how and technical help.

### Bike and Barge Cruises

A cycling vacation with guided rides from the barge, along local roads and the smooth towpath. Non-cyclists are also welcome.

### Wine Cruises

Tours and tastings at renowned vineyards, with visits to Chablis and Beaune and, in the upper Loire Valley, Sancerre and Pouilly.

### Walking Cruises

The itinerary blends guided walks through beautiful Burgundy countryside, daily excursions and cruising on the glorious Nivernais.

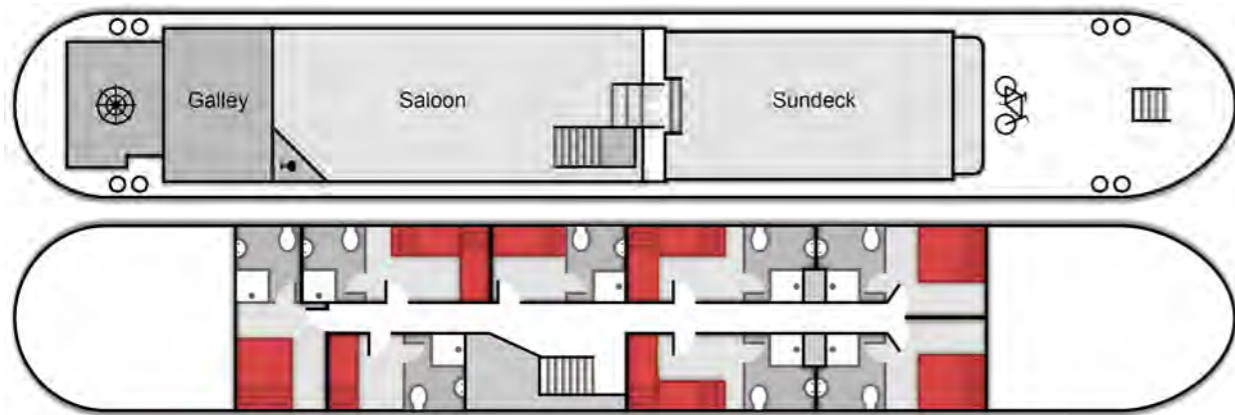

The Luciole accommodates twelve passengers in eight en-suite cabins and is available for whole boat charter or individual bookings.

Our all-inclusive cruise rate covers six nights accommodation, all meals and drinks served on board and travel in the Luciole's bus for excursions with our Tour Guide. Transfers between Paris and the barge are also included.

We rendez-vous on Sunday afternoons at the Hotel Mansart in central Paris. Luggage may be left here by those arriving early, before transfer to the Luciole in our private bus.

Served to you on board:  
 Continental breakfast  
 Two course buffet lunch  
 Four course evening dinner  
 Wine and 'open bar'  
 Tea, coffee, snacks and canapés  
 Dietary requests can easily be catered for by the Luciole's chef.

Up-to-date cabin availability and further information can be found on our website:

[www.bargeluciole.com](http://www.bargeluciole.com)

Crew	Dimensions	Throughout	Exterior	Saloon	Cabins	Bathrooms
Captain	Length 114 ft	Non-smoking	Large raised	Large picture	3 Doubles (or twin)	En-suite
Tour Guide	(34 metres)	220v electricity	sundeck with	windows	3 Twins	Molton Brown
Chef	Beam 16.5ft	Air conditioning	table and chairs	Comfortable	2 Singles	toiletries
Two hosts	(5.05 metres)	Heating	Electric and normal	sofa and chairs	Opening windows	Towels
Matelot (deckhand)			bicycles, plus	Dining area	USB charging	Hair dryers
			helmets	Mobile Wi-Fi	points	
				Open and well	Good storage	
				stocked bar		
				Library		
				Music system		





[www.bargeluciole.com](http://www.bargeluciole.com)  
[info@bargeluciole.com](mailto:info@bargeluciole.com)