

Renaissance

Upper Loire & Western Burgundy



Renaissance: 🏠 Ultra Deluxe | 🐾 8 Passengers | 🧑 5 Crew

Renaissance has been designed to carry her guests in ultimate luxury along the Canal de Briare, France's oldest canal, completed in 1642 and steeped in history on a cruise route that features elegant châteaux, small countryside villages and the famed wine-growing region of Sancerre.

She is a very spacious hotel barge and the beautifully-appointed saloon with its wooden beams, classic dining furniture and artwork, invokes the atmosphere of a classic French manor house. The comfortable leather sofas and hand-built bar where you can enjoy your pre-dinner aperitif, add to the feeling of onboard opulence.

The 'Renaissance mood' extends to the four very generously-sized twin or double bedded bedroom suites, (approx. average 250sq ft including en suite), each one fully air-conditioned and complemented by a large en suite shower room.

Outside, the large forward deck includes a covered roof extension with a circular table for alfresco dining, comfortable hardwood sun loungers and a heated spa pool.

With her refined onboard ambience, Renaissance is the perfect vessel on which to cruise a historic canal and experience the splendour of landmarks en route, including Gustav's Eiffel's aqueduct across the mighty River Loire.

Cruise Highlights

- Visit the "time capsule" studio home of 19th century artist Rosa Bonheur and lunch in her salon
- Tour of the privately-owned Château de La Bussière, including a cooking demonstration using seasonal produce from the gardens
- 7-lock flight at Rogny-Les-Sept-Ecluses, a national historic monument
- Cruise across the aqueduct at Briare, built by Gustave Eiffel over the River Loire
- Private wine tasting at the renowned Sancerre winery of La Perriere
- Excellent opportunities for walking and biking. Biking Plus option available

“Ultimate luxury
on board our flagship”



Studio Home of
Rosa Bonheur



La Perrière



Château de Ratilly



Suite

View
deck plan
on page 101

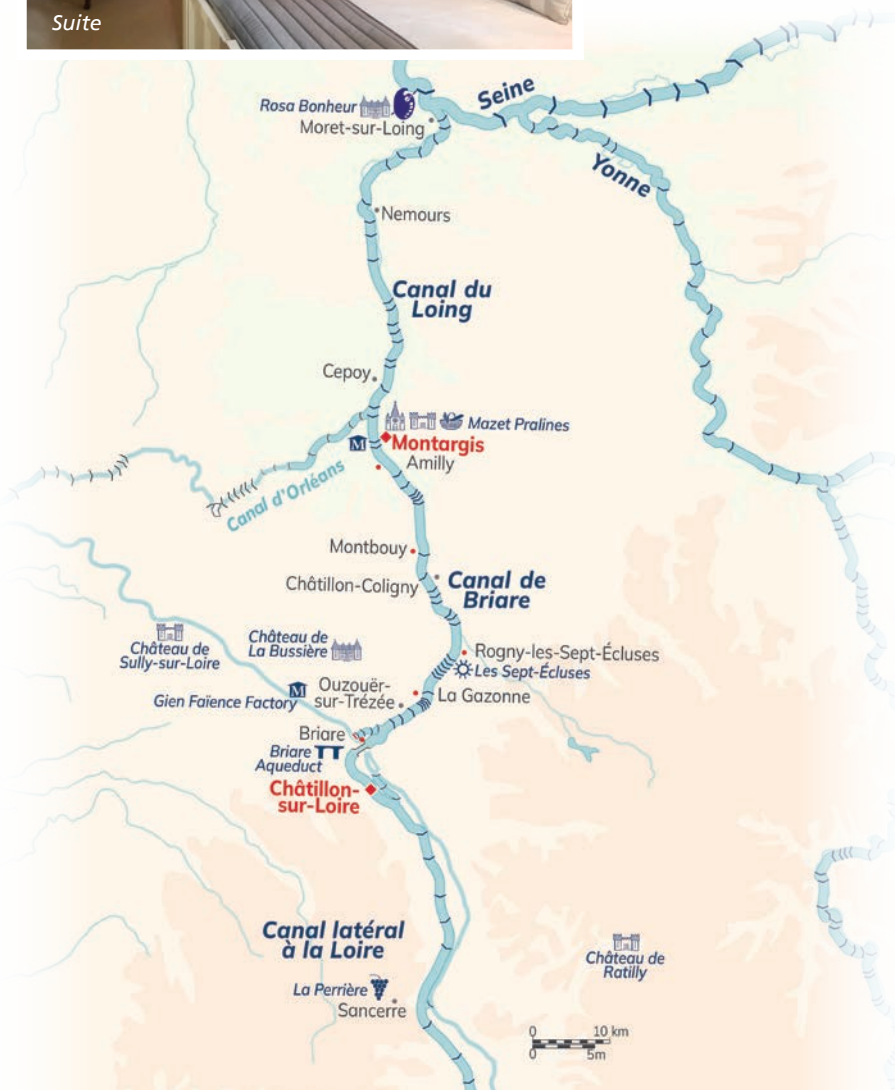

ITINERARY

Montargis to Châtillon-sur-Loire

Day 1 Montargis to Amilly

Guests are met at The Hotel Westminster in Paris and transferred by private chauffeured minibus to Renaissance where a champagne welcome awaits them. We enjoy an afternoon cruise through the picturesque "little Venice of Gâtinais". Dinner on board.

Day 2 Amilly to Montbouy

This morning we cruise through the Loire countryside to moor at Montbouy. After lunch, we visit the privately-owned Château de La Bussière, known as the 'Fishermen's Castle', with its wonderful ornamental and vegetable gardens, where we enjoy a cooking demonstration with the barge chef using seasonal produce from the gardens. Dinner on board.

Day 3 Montbouy to Rogny-les-Sept-Ecluses

After breakfast we explore the town of Montargis, exploring the 11th century château, 12th century Church and the Fishermen's Quarter. Our footsteps finally bring us to Mazet, the confectioners renowned for creating the original praline recipe and enjoy a tour and tasting. Later, we enjoy an afternoon cruise to the village of Rogny-les-Sept-Ecluses, near its 350-year-old 7 lock-flight. A short stroll to the locks is worthwhile before dinner on board.

Day 4 Rogny-les-Sept-Ecluses to La Gazonne

After breakfast we enjoy a short walking tour of Moret-sur-Loing, famous for its association with the Impressionist painter Alfred Sisley. We then head to the Château de Rosa Bonheur – home to the most celebrated female artist of the 19th Century. We take lunch in the private salon before joining the present owner for a tour and to hear more about the history of this remarkable lady and view some of her works. Later, we enjoy an afternoon cruise to La Gazonne. Dinner on board.

Day 5 La Gazonne to Briare

A morning cruise to our mooring at the little town of Briare, site of Gustave Eiffel's magical aqueduct across the River Loire. We preview Friday's crossing of this amazing 10,000-ton, 662 metre Pont Canal which was completed in September 1896. Our afternoon visit is to the renowned Sancerre winery of La Perrière, for a tour and private tasting. Dinner on board.

Day 6 Briare to Châtillon-sur-Loire

This morning we wander around fresh produce stalls in the market in Briare, before making a short cruise across the Briare aqueduct with lunch on board. This afternoon, we visit the delightful 13th Century Château de Ratilly with its spectacular selection of turreted towers. In the castle's workshops, we see traditional pottery being made and learn about this artisanal craft for ourselves. Captain's Farewell Dinner on board.

Day 7 Châtillon-sur-Loire

After breakfast, guests are transferred by private chauffeured minibus to Paris.

Themed Cruises Available:

■ Family ■ Golf ■ Wine Appreciation

Renaissance - Fact Sheet

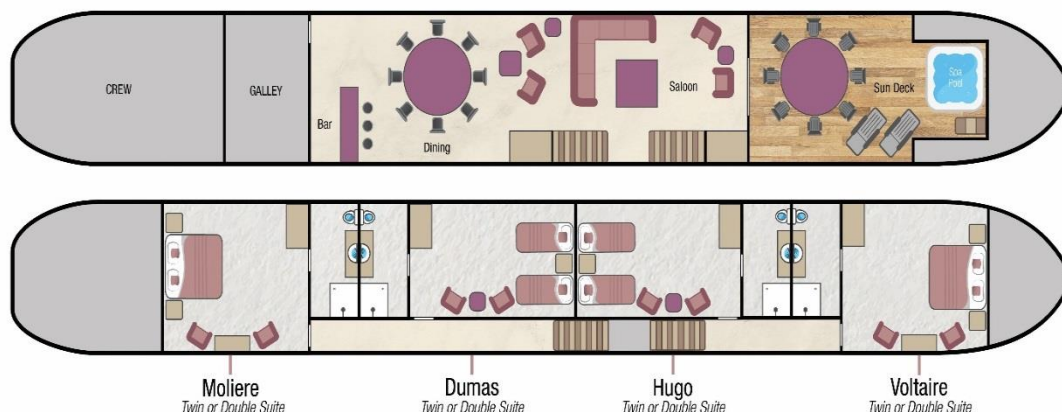

Barge Specifics



Former purpose:	Ex French cargo carrier
Year of construction:	1960
Dimensions:	128ft (39m) x 17ft 6" (5.3m)
Year converted into a hotel barge:	1997
Cabins completely refurbished:	2015
Generators:	2 x 220 volt generators
Main engine:	Main engine 250 HP BAUDOUIN
Maximum speed:	10 knots
Water & fuel capacity:	6 tons of water & 3 tons of fuel

Your crew on board

Crew of 5:	Captain/Pilot, Tour Guide/ Deckhand, Chef, Housekeeper & Hostess.
Nationality of crew:	Mainly British, speaking both English & French.

Accommodation on board

Maximum 8 passengers / 4 suites

All suites can be configured with either 2 single beds or 1 king-size bed.

Each Suite has a large & stylish en-suite bathroom with shower, wash basin and WC. The bathrooms have fully tiled floors and walls. All are supplied with washing gel, hand soap, shampoo, towels, bathrobes, slippers and hair dryer.

Voltaire and Moliere Suites both have a chest of 3 drawers and a wardrobe 140cm high x 48cm deep x 133cm wide.

There are 4 portholes in each of the cabins, 2 on port side and 2 on starboard side. They can be opened, but not while cruising.

Hugo and Dumas Suites have 2 portholes, which can be opened but not during cruising. Both cabins have a wardrobe which slants under the stairwell. These are very deep and have 3 shelves behind the rails where suitcases can be stored. The wardrobe height is 155cm at its highest x 98cm deep and the clothes rail is 88cm wide.

Each suite has a TV/DVD player

Cabin Sizes

Moliere Suite (stern) & **Voltaire Suite** (bow) each measure: 15ft 9" x 16ft 9" (4.8m x 5.1m) equating to 265 ft² (24.5 m²)

Dumas Suite & Hugo Suite (mid) each measure: 12ft 6" x 18ft 5" (3.8m x 5.6m) equating to 235 ft² (21.5 m²)

Bathrooms: are en-suite and average 60 ft² (5.6 m²) in area. The bathroom measurements are included in the suite sizes detailed above.

Ceiling height: The height in the suites is 6ft 6" (2m)

All sizes are approximate.

Size of the beds:

As singles the beds are 3ft 5" x 6ft 10" (1.05m x 2.1m)

As a king bed 6ft 10" (2.1 m).

Climate Control

Each Suite has individually controlled Air Conditioning and Central Heating.

Computer and Telephone

Complimentary Wi-Fi is available on board for guests bringing their own appliances. Connectivity can be limited in remote locations.

There is no passenger telephone on Renaissance.

Currency

The local currency in France is the Euro.
We are unable to accept credit or debit cards on board.

Cycling & Walking

You are welcome to walk or cycle using the on-board bicycles as often as you wish. Most guests choose to disembark the barge at a lock and visit local villages, returning to the canal and meeting the barge a little further along. The barge travels at a slow speed therefore catching up is not a problem.

There are 8 Touring Bikes on-board. Children's bikes, helmets and child bike seats can be arranged if required on request - please contact our reservations department at least 8 weeks prior to your departure.

Dining Room & Saloon

The Saloon is a wonderful place to relax. It is light & airy and measures 42ft x 17ft (13m x 5m) and is furnished with sofas, a coffee table, two very comfy lounge chairs and a fully stocked bar which is open 24/7.

The height of the saloon is 7ft (2.15m).

Antique wood panelling, wallpapers, a beamed ceiling and brass light fittings run throughout the area with tiled floors and Renaissance paintings on the walls. The large round oak dining table seats 8 guests.

Electricity

The barge is wired for 220 and 240 volts but not 110 volts. We suggest you bring an adapter for your particular appliance, which corresponds to the standard French two-pin plugs. If you wish to use your electrical appliance on board, please speak to a crew member on arrival to ensure it is suitable for the barge's electrical system.

European Waterways cannot be held responsible for unforeseen voltage fluctuations which sometimes occur when swapping from one voltage system to another.

Excursions

The Renaissance barge minibus is a 9-seater (including driver) air-conditioned long wheelbase Mercedes Sprinter. It is used for transfers and excursions during your cruise.

For charter bookings, the itinerary can be adapted to suit your group's particular needs. If a destination or excursion is within a reasonable distance of the barge, we will do everything we can to arrange it. Please speak with our Reservations team in advance of your cruise and we can pre-arrange with the Captain.

Any guests not wishing to participate in an excursion are welcome to remain on the barge.

Facilities on board

- 4 person spa pool (hot tub)
- 8 Bicycles (See Cycling & Walking)
- A small library of books and maps
- A collection of board games
- Fishing rods
- Nordic walking sticks (on request)
- Bose Hi-fi system with an iPod docking station and radio. There is a selection of CDs.
- Guest iPods can be connected to the Hi-Fi system
- Each suite has a TV/DVD player

Food & Drink

All meals on board are freshly prepared by your chef and most meals are a set-menu (there is no choice available). International & regional French cuisine is served

We are able to arrange special meals, e.g. vegetarian / no fish / vegan etc, and we are able to cater for any preferences or allergies. However, it is most important that we are notified of any specific requirements at least 8 weeks prior to your departure date. Failure to notify European Waterways in advance of your cruise may result in disappointment on board.

There is no assigned seating for meals and the dining room on board Renaissance accommodates all guests at a single sitting.

Breakfast: Your day on Renaissance starts with a wholesome and balanced variety of breakfast foods, along with fresh breads & pastries, freshly-squeezed orange juice and hot beverages.

Lunch usually consists of colourful salads, pates and cold meats accompanied by hot soup or entrée, delectable desserts and a different selection of regional cheeses accompanied by quality wines selected by the chef.

Dinner: Always a gastronomic adventure created by your talented chef. A taste of regional cuisine by candlelight,

complemented by fine wines, followed by a selection of regional cheeses, coffee and liqueurs.

Captain's farewell dinner is held on the last night of your cruise. Guests may choose to dress slightly more formal.

Drinks included in the cruise price: Non-alcoholic beverages and regular or decaffeinated tea and coffee, whole or low fat milk, are offered with all meals. The well-stocked bar is open 24 hours, which includes wines, spirits, beers & soft drinks. All wines are provided with meals and there is a Champagne welcome on arrival.

Drinks not included in the cruise price: Some Champagnes (with the exception of the Captain's reception) and special vintage wines, however these can be purchased in advance of your cruise at cost price – please speak to our reservation team. We do not recommend specific beverage orders unless you are chartering the whole barge.

Hot Air Ballooning

Once on board, the Captain can arrange this directly with the hot air balloon company on your behalf. Flights usually last between 1 and 1½ hours and are weather dependent. The cost is approximately 250 Euros per person. You will need to contract and pay the balloon company directly on the day of the flight (they do accept credit cards).

Kindly advise our Reservations team in advance if you are interested in ballooning. The main balloon operators we work with are Air Escargot www.air-escargot.com and France Montgolfieres www.franceballoons.com

Laundry

We recommend you bring sufficient clean clothing for your cruise as there are no laundry facilities on board. However, the crew may be able to assist in an emergency on a request basis.

Luggage / What to pack

Please try and fit everything for your cruise into one reasonably sized suitcase per person. Soft bags are preferable. There is only enough space on the barge transfer bus for up to 8 suitcases and 8 pieces of hand luggage.

Practical comfort and casual clothing is the norm aboard Renaissance and for most excursions. The dress code for dinner is relaxed and informal. For the Captain's Farewell Dinner on the final evening, guests often dress-up, which is optional.

The weather in Burgundy is generally warm. June, July, and August is the warmest often being in the mid 30's.

Suggested things to pack:

- Light clothing including shorts and T-shirts. A sweater or lightweight jacket is recommended for evenings and the air-conditioned interiors.
- During spring and autumn, you may need medium weight clothing. A lightweight raincoat for showery times would be advisable.
- In summer, a sun hat can be useful.
- Comfortable walking shoes with textured non-slip soles are recommended.
- Renaissance has a spa pool so don't forget your swim wear. Towels are provided.

Medical

Please let us know in advance of your cruise if you require frequent or ongoing medical attention.

The crew are unable to administer medicines but can accompany you to a chemist for you to purchase any necessary medicines. Due to your cruise often being in a rural location, we recommend you bring all necessary medication with you.

Doctors are usually not far away for an urgent consultation and the Emergency Services can be called if required.

Problem during your Cruise

If you have a problem during your cruise, please give us the immediate opportunity to make things right. Please bring any concern to the private attention of your Captain who will often be able to solve any issue immediately.

Restricted Mobility

Please let us know in advance of your cruise if you have a physical disability and require any assistance.

Renaissance has a gangplank to the deck level from the bank of the canal with one handrail. There are no steps from the deck to the saloon but there are 14 steps between the saloon & the lower deck and the cabins.

Wheelchairs cannot be used on-board and can only be used to help get round on excursions, however often there are cobbled streets or rough ground which may hinder a wheelchair.

If you would like to hire a wheelchair to be available for your arrival, please notify our Reservations team at least 8 weeks before departure. The small hire charge should be paid directly to the barge Captain on arrival and is approximately 100 Euros.

Safety and Security

Once you are on board, your Captain will talk you through the Cruise Safety Procedures. Safety Instructions are detailed on the last page of this document.

Please note that European Waterways cannot be responsible for any valuables that you bring on board. We strongly recommend that you do not bring valuables with you unless required and that you ensure that all valuables are covered by your travel insurance.

Safes are provided in each cabin on board but cabin doors are not usually locked for safety reasons.

Smoking

We have a strict non-smoking policy for safety reasons and for the comfort of your fellow passengers.

If you would like to smoke, we request that you do so outside or on the deck away from fellow passengers.

Sundeck

The outdoor deck is 17ft 6" x 22ft (5.3m x 6.7m) and is equipped with a 4 person heated spa pool and 2 long wooden sunbed chairs. There are also 8 reclining chairs and a large table for al-fresco dining beneath a covered deck area.

Themed Cruises

Wine Appreciation, Golf and Family cruise itineraries are available for charter groups, please contact our Reservations team for more details. Special interest cruises often have a supplement and further details can be found at

Tipping

Gratuities are not included in the cruise fare. Tipping is entirely discretionary but is greatly appreciated by the crew if you are fully satisfied with the level of service on board. As a guideline, the average tip given by our guests from around the world is approximately 5% of the Cruise Fare.

The usual way to give the tip is to give the amount in cash as one lump sum to the Captain / Cruise Director on the last day of the cruise. They will distribute the amount equally amongst the crew.

Euros or Dollars are equally appreciated. ATMs are accessible for cash withdrawal on most itineraries during the cruise and the crew can advise where these are located.

Transfers

For details of the Renaissance vehicle, please see "Excursions". The approximate transfer duration between Paris & Renaissance is 2 or 2.5 hours depending on the cruise direction.

Water

Tap water in France and on board Renaissance is potable and bottled water is available.

Safety Instructions on Renaissance

On arrival the Captain will talk you through the Cruise Safety Procedures on board.

In addition, it is important that all passengers are familiar with the safety instructions detailed below.

- Please follow the instructions of the Captain and crew at all times.
- Remember that decks can be slippery. Please wear non-slip shoes and do not run or jump whilst on board.
- Do not walk on the side or rear decks or outside the guard rails.
- Passengers are not permitted in the engine rooms, technical areas or crew accommodation at any time, or in the galley or wheelhouse unless accompanied by a crew member.
- Do not embark or disembark the barge unless the gangplank and handrail are in place or the crew have advised that it is safe to do so. Never do so when the barge is moving.
- Be careful when the vessel is being moored up with the barge ropes. In particular do not step into a loop in the rope or try to release the mooring rope from a bollard.
- Keep clear of any overhead obstructions and remain seated if on deck whilst the barge passes under bridges with restricted headroom.
- Do not attempt to touch the sides of any lock or bridge.
- Do not open lower deck portholes whilst the barge is moving.
- Life jacket preservers are located in designated lockers in your cabin or in designated deck lockers. Once on board, please take the time to identify their location and read the instructions.
- For fire safety reasons, smoking is not permitted anywhere inside the barge.
- The barge's equipment such as the hot tub and bicycles must only be used following preparation by the crew. Use of the bicycles and the hot tub is at your own risk. Breakable glasses are not permitted in the hot tub and alcohol consumption is not advised.
- There is an open bar policy on board. However, excessive alcohol consumption can be dangerous, particularly in a warm climate and in proximity to deep water and the Captain has the discretion to withhold alcohol if safety to passengers or crew is at risk.

In an emergency

- Keep calm. Do not return to your cabin to recover your possessions.
- If you discover a fire on board, sound the fire alarm and notify a crew member immediately. If possible, close doors behind you to confine the fire. Please take the time to identify the location of fire alarms and fire extinguishers.
- If the alarm sounds or you hear repeated continuous blasts on the barge horn, you must, if possible, assemble on the sundeck for further instructions.
- If you discover water below deck, notify a crew member immediately and go to the sundeck to await further instructions.
- If you are in your cabin and the way to the sundeck is obstructed, follow the signs to the alternative fire exit. Please take the time to identify all fire exits.
- The emergency number for fire, police or medical assistance on all public phone networks is 112.

Please ask a member of the crew on board if you require any further safety advice