

Scottish Highlander

The Caledonian Canal,
Loch Ness & the Highlands



Scottish Highlander: 🏠 Deluxe | 👤 8 Passengers | 👤 5 Crew

Scottish Highlander has the atmosphere of a comfortable Country House with subtle use of tartan furnishings and landscape paintings, a reminder of the spectacular surroundings to be seen on your voyage through the Great Glen.

At 117 feet long, she is spacious and has every comfort needed for enjoying the magnificence of the Highlands during Spring, Summer and Autumn.

The warm and welcoming saloon features rich-coloured wooden panelling, large picture windows and comfortable leather Chesterfield sofas to relax in, perhaps with a mellow single malt whisky from the very well-stocked bar.

Accommodation for eight guests is in three twin/double staterooms and one larger twin/double junior suite, each one centrally heated and with en suite facilities.

There is a cosy observation area behind the wheelhouse where you can admire the passing scenery and chat to the Captain about life on the Caledonian Canal and its interconnecting lochs. On the forward deck area there is more seating where you can appreciate the far-reaching views and rugged highland landscape.

If you're a fan of a wee dram then our Whisky Trail Cruise could be the ultimate getaway for you. For more information please see page 17.



Cruise Highlights

- Tour of the Dalwhinnie whisky distillery with a private tasting
- Majestic Falconry Display on the banks of Loch Ness
- Tour Cawdor Castle and gardens, home of Shakespeare's Scottish Play
- Visit Eilean Donan Castle, featured in "The World is not Enough" & "Highlander"
- Wonderful river, canal and loch cruising & excellent opportunities for walking
- Visit Culloden Moor, scene of the last major battle on British soil in 1746

“A journey through
the majestic Highlands”



Urquhart Castle



The Highland Club



Dalwhinnie Whisky Distillery



Cameron Suite

ITINERARY

Muirtown to Banavie

Day 1 Muirtown

Guests are met at the Kingsmills Hotel in Inverness and transferred by private chauffeured minibus to Scottish Highlander where a champagne welcome awaits you. Dinner on board.

Day 2 Muirtown to Dochgarroch

Our first cruise will take us up the Muirtown lock flight to Dochgarroch. After lunch on board, we visit Culloden Moor, scene of the last major battle on British soil in 1746. If time allows, then we take a tour of Clava Cairns, a pre-historic clan chieftain burial site dating back to 2,000 B.C and setting for the Outlander TV series. Dinner on board.

Day 3 Dochgarroch to Fort Augustus

This morning we enjoy Cawdor Castle, forever immortalised in Shakespeare's Macbeth. After lunch on board, we cruise Loch Ness pass Urquhart Castle, navigating closely beneath its spectacular 13th century ruins, before continuing our cruise to Fort Augustus. Dinner on board.

Day 4 Fort Augustus to Kytra

After breakfast, we visit the private, Highland Club, a spectacular exclusive set of residences and a former 19th century Benedictine Monastery. It is here we are treated to a falconry and birds of prey demonstration on the banks of Loch Ness. Following lunch onboard there is time to explore the village of Fort Augustus before we cruise up the "flight" to our mooring at Kytra. This evening we dine ashore at a local restaurant.

Day 5 Kytra to Laggan

This morning, we cross the scenic Loch Oich and on to our mooring at Laggan. After lunch onboard we visit Eilean Donan Castle, a well-known spot amongst film aficionados having featured in "The World is not Enough" & "Highlander." Dinner on board.

Day 6 Laggan to Banavie

Our final cruise today will see us cross Loch Lochy to the small settlement village of Banavie. After lunch on board, our tour today takes us to Dalwhinnie Distillery for a tour and private tasting of several single malts. If time permits, we can also visit the ruins of Old Inverlochy Castle. Captain's Farewell Dinner on board.

Day 7 Banavie

After breakfast, guests are transferred by private chauffeured minibus to their choice of location in Inverness.

Themed Cruises Available:

■ Family ■ Golf ■ Honeymoon ■ Whisky Trail



Scottish Highlander - Fact Sheet

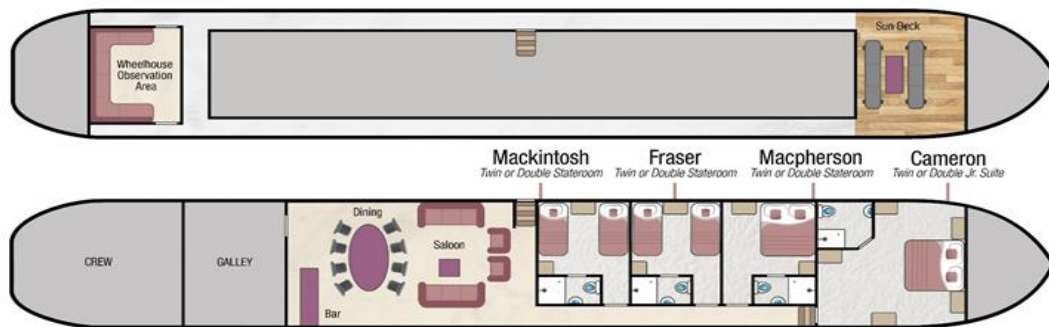

Barge Specifics



Former purpose: Cargo Barge operating in Holland
Original year of construction: 1931
Dimensions: Length 117ft (35.66m) Width 16ft 6" (5m)
Year converted to a Hotel Barge: 2000
Generators: 2 x Cummins Onan 27kva generators
Main engine: Gardner 6LX 127HP
Maximum speed: 7.5 knots
Water & fuel capacity: 8 tons of water and 3 tons of fuel

Your crew on board

Crew of 5: Captain, Chef, Tour Leader, Hostess
& Deckhand. All staff speak English

Accommodation on board

Maximum 8 passengers / 1 Suite and 3 Staterooms

All cabins can be configured with either 2 single beds or a double bed.

All cabins have an en-suite bathroom, wardrobes, drawers and a bedside table with reading light. The fittings are of solid mahogany.

In the 3 staterooms, the top of the beds are positioned in the recess beneath the 2 large picture windows, one of which opens.

The Cameron Suite has 4 porthole windows which all open.

Cabin Sizes

Cameron Suite (Bow) 12ft x 12ft 4" (3.65m x 3.77m)
Macpherson Stateroom (Mid) 11ft 6"x 10ft (3.53m x 3m)
Fraser Stateroom (Mid) 11ft 6"x 10ft (3.53m x 3m)
Mackintosh Stateroom (Mid Stern) 11ft 6"x 10ft (3.5m x 3m)

Bathrooms: The Cameron Suite bathroom measures approximately 4ft 6" (1.4m) x 6ft 2" (1.85m)
The stateroom bathrooms each measure 2ft 7" x 4ft 4" (0.8m x 1.3m)

Ceiling height: The ceiling height in the Cameron Suite is 6ft 6" (2m) but gets a little higher in some parts. The height in all the Staterooms is 6ft 9" (2.1m)

Size of the beds:

In the Cameron Suite the double bed measures 5ft wide x 6ft 3" (1.5m x 1.92m) or as 2 single beds, each measures 2ft 6" wide x 6ft 3" (0.9m x 2m) with a small gap of 4cm between the beds.

In the Staterooms as a double 6ft wide (1.85m) x 6ft 6" (2m) or as 2 single beds, each measures 3ft (1m) wide x 6ft 6" (2m).

All sizes are approximate

Bathrooms: All cabins have a shower, wash-basin and WC. The bathrooms are fully lined & have a heated towel rail, 110v shaver socket and an air extractor fan (except the Cameron Suite which has a porthole). Towels, hand soap, shower gel, shampoo, hair dryers, slippers and bathrobes are all provided.

Climate Control

The barge has household style central heating.

Air conditioning unit in Saloon area.
Each cabin has a cooling fan.

Computer and Telephone

Complimentary Wi-Fi is available on board for guests bringing their own appliances. Connectivity can be limited in remote locations.

There is no passenger telephone on board Scottish Highlander.

Currency

The Local currency in Scotland is GBP Pound Sterling. We are unable to accept credit or debit cards on board.

Cycling & Walking

You are welcome to walk or cycle, using the on board bicycles. Most guests choose not to miss any cruising and tend to cycle or walk when the barge is stationary.

Cycling opportunities can be limited on certain days due to the differing terrain along the cruise route.

There 4 general purpose and 4 folding bikes on board. Children's bikes, helmets and child bike seats can be arranged if required on request – please notify our reservations team at least 8 weeks prior to your departure.

Dining Room & Saloon

20ft long (6.1m) x 12ft wide (3.6m)
Accessed from the main sundeck by a double door and then 5 steps down. The saloon is finished in yew and Brazilian mahogany and there are 7 observation windows.
For relaxation there are 2 leather armchairs, 2 Chesterfield sofas, and a coffee table.

In the dining area of the saloon the dining table seats up to 9 guests. There is a long fully stocked bar with fridge.

Tartan carpet runs throughout the saloon leading into a corridor accessing the 4 cabins. The dining area has a wooden floor.

Electricity

The barge is wired for 240 volts with 110 volt sockets in the bathrooms for shaving. We suggest you bring an adapter for your particular appliances, which should correspond to the standard UK 3 pin plug. There are also 2 USB ports in each cabin for re-charging phones, I-pads, laptops etc.

If you wish to use your electrical appliance on board, please ask one of the crew when you arrive on board to ensure that it is suitable to the barge's electrical system.

European Waterways cannot be held responsible for unforeseen voltage fluctuations which sometimes occur when swapping from one voltage system to another.

Excursions

The Scottish Highlander barge has a very comfortable 9-seater (including driver) air-conditioned minibus. Which is used for transfers and excursions.

For charter bookings, the itinerary can be adapted to suit your group's particular needs. If a destination or excursion is within a reasonable distance of the barge, we will do everything we can to arrange it. Please speak with our Reservations team in advance of your cruise and we can pre-arrange with the Captain.

Any guests not wishing to participate in an excursion are welcome to remain on the barge.

Facilities on board

- 8 Bicycles (See Cycling & Walking)
- A small library of books and maps
- A collection of board games
- Binoculars for watching the wild bird life
- Hi-Fi system with CD player and radio
- There is a small CD selection on board.
- Wi-Fi internet access is available for passengers bringing their own appliances. (Please see Computer & Telephone).
- There is a compass, depth sounder, chart plotter with AIS in the wheelhouse.

Food & Drink

All meals on board are freshly prepared by your chef and most meals are a set-menu (there is no choice available). International and traditional Scottish cuisine is featured.

We are able to arrange special meals, e.g. vegetarian / no fish / vegan etc; and we are able to cater for any preferences or allergies. However, it is most important that we are notified of any specific requirements at least 8 weeks prior to your departure date. Failure to notify European Waterways in advance of your cruise may result in disappointment on board.

There is no assigned seating and the dining table accommodates all guests at a single sitting.

Breakfast: Full Scottish cooked breakfast or Continental-style buffet breakfast with toast, fruit, cereals, fruit juices, decaffeinated or regular tea and coffee.

Lunch: Usually consists of a light buffet with salads, pates and fish dishes. Occasionally you can enjoy a picnic out and

sometimes a 3 course sit-down lunch or hot soups on colder days.

Dinner: Always a gastronomic adventure by your talented chef. A taste of regional cuisine by candlelight, harmonizing food and good wines, followed by a selection of regional cheeses, coffee and liqueurs.

Captain's Farewell Dinner: Captain's dinner on the last night of the cruise. Guests may choose to dress slightly more formal.

Drinks included in the cruise price: Non-alcoholic beverages and regular or decaffeinated tea and coffee. There is also a Nespresso Coffee machine available with an a la carte menu of speciality coffees. The well-stocked bar is open 24 hours, which includes wines, spirits, Scottish single Malt Whiskies, beers & soft drinks. All wines are provided with meals and there is a Champagne welcome on arrival.

Drinks not included in the cruise price: Some champagnes, whiskies and special vintage wines are not included although you may purchase bottles in advance of your cruise at cost if you notify us in advance how many you require. We do not recommend specific beverage ordering unless you are chartering the whole barge.

Hot Air Ballooning

The region Scottish Highlander cruises in is not suitable for hot air ballooning.

Laundry

We recommend you bring sufficient clean clothing for your cruise as there are no laundry facilities on board. However, the crew may be able to assist in an emergency on a request basis.

Luggage / What to pack

Please plan to travel with one suitcase per person. Soft-sided luggage will be easier to store once you have unpacked. There is a limited amount of space on the barge & minibus.

Practical comfort and casual clothing is the norm aboard Scottish Highlander and for most excursions. Dress code for dinner is relaxed and informal. For the Captain's Farewell Dinner on the final evening, guests often dress-up which is optional.

Suggested things to pack:

A sweater or lightweight jacket for evenings.

A sun-hat in the summer is recommended.

During spring and autumn cruises we recommend layered clothing as well as a substantial warm raincoat.

Comfortable walking shoes with low or no heels and textured non-slip soles.

Umbrellas are available on board.

Medical

Please let us know in advance of your cruise if you require frequent or ongoing medical attention.

The crew are unable to administer medicines but can accompany you to a chemist for you to purchase any necessary medicines. Due to your cruise often being in a rural location, we recommend you bring all necessary medication with you. Doctors are usually not far away for an urgent consultation and the Emergency Services can be called if required.

Problem during your Cruise

If you have a problem during your cruise, please give us the immediate opportunity to make things right. Please bring any concern to the private attention of your Captain who will often be able to solve any issue immediately.

Restricted Mobility

Please let us know in advance of your cruise if you have a physical disability and require any assistance.

Scottish Highlander has boarding steps with 2 handrails from the bank to the main deck. The gradient can sometimes be steep.

There are 5 wide stairs from the main deck down to the saloon with handrails on both sides. The staterooms are on the same level as the main Saloon. To access the Cameron suite, there are 3 stairs down from the stateroom corridor with a single handrail.

We are able to hire wheelchairs locally – a small charge may apply. Please notify our reservations department at least 8 weeks prior to your departure. Please note wheelchairs are not suitable for use on board. Passengers must be accompanied by someone who is able to push the chair as the crew are unable to assist.

Safety and Security

Once you are on board, your Captain will talk you through the Cruise Safety Procedures. Safety Instructions are detailed on the last page of this document.

Please note that European Waterways cannot be responsible for any valuables that you bring on board. We strongly recommend that you do not bring valuables with you unless required and that you ensure that all valuables are covered by your travel insurance.

There is a safe located in each cabin. Cabin doors are not locked for safety reasons.

Smoking

We have a strict non-smoking policy for safety reasons and for the comfort of your fellow passengers.

Sundeck

There is an outside deck area at the Bow of the barge with a large table and seating for 8 guests.

Themed Cruises

For charter groups only, Golf, Walking (along the banks of Loch Ness and the Great Glen), Fishing, Whisky and Family Cruises are available on request. We can also adapt our cruise to include horse-riding. Please contact our Reservations Team for details or go to

Tipping

Gratuities are not included in the cruise fare. Tipping is entirely discretionary but is greatly appreciated by the crew if you are fully satisfied with the level of service on board.

As a guideline, the average tip given by our guests from around the world is approximately 5% of the Cruise Fare.

The usual way to give the tip is to give the amount in cash as one lump sum to the Captain / Cruise Director on the last day of the cruise. They will distribute the amount equally amongst the crew.

Sterling, Euros or Dollars are equally appreciated. ATMs are accessible for cash withdrawal on most itineraries during the cruise and the crew can advise where these are located.

Transfers

For details of the Scottish Highlander vehicle, please see "Excursions". The approximate transfer duration is 15 minutes or 2 hours depending on the cruise route.

Water

Tap water in Scotland and on-board Scottish Highlander is potable, but we advise guests to use the bottled water provided in each suite.

Safety Instructions on Scottish Highlander

On arrival the Captain will talk you through the Cruise Safety Procedures on board.

In addition, it is important that all passengers are familiar with the safety instructions below.

- Please follow the instructions of the Captain and crew at all times.
- Remember that decks can be slippery. Please wear non-slip shoes and do not run or jump whilst on board.
- Do not walk on the side or decks outside the guard rails.
- Passengers are not permitted in the engine rooms, technical areas or crew accommodation at any time, or in the galley or wheelhouse unless accompanied by a crew member.
- Do not embark or disembark the barge unless the gangplank and handrail are in place or the crew have advised that it is safe to do so. Never do so when the barge is moving.
- Be careful when the vessel is being moored up with the barge ropes. In particular do not step into a loop in the rope or try to release the mooring rope from a bollard.
- Keep clear of any overhead obstructions and remain seated if on deck whilst the barge passes under bridges with restricted headroom.
- Do not attempt to touch the sides of any lock or bridge.
- Do not open lower deck portholes whilst the barge is moving.
- Life jacket preservers are located in designated lockers in your cabin or in designated deck lockers. Once on board, please take the time to identify their location and read the instructions.
- For fire safety reasons, smoking is not permitted anywhere inside the barge.
- The barge's equipment such as bicycles can only be used when prepared by the crew. Use of the bicycles is at your own risk.
- There is an open bar policy on board. However, excessive alcohol consumption can be dangerous, particularly in a warm climate and in proximity to deep water and the captain has the discretion to withhold alcohol if safety to passengers or crew is at risk.

In an emergency

- Keep calm. Do not return to your cabin to recover your possessions.
- If you discover a fire on board, sound the fire alarm and notify a crew member immediately. If possible, close doors behind you to confine the fire. Please take the time to identify the location of fire alarms and fire extinguishers.
- If the alarm sounds or you hear repeated continuous blasts on the barge horn, you must, if possible, assemble on the sundeck for further instructions.
- If you discover water below deck, notify a crew member immediately and go to the sundeck to await further instructions.
- If you are in your cabin and the way to the sundeck is obstructed, follow the signs to the alternative fire exit. Please take the time to identify all fire exits.
- Scottish Highlander is equipped with a defibrillator for use in case of cardiac arrest. Instructions in English are given automatically by the machine.
- The emergency number for fire, police or medical assistance on all public and mobile phone networks is 112.

Please ask a member of the crew on board if you need further safety advice